

Advantages

- Low power consumption
- Extended measuring range
- Excellent noise resistance

Open Loop Type

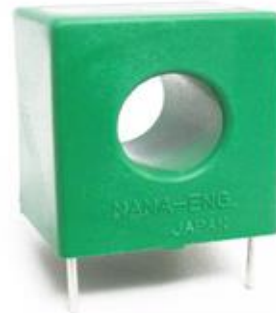

Specifications

Ta=25°C

Product name	Code:2045		CK2-075S
	Symbol	Unit	
Nominal input current	If(n)	AT	±75
Saturation current	If(s)	AT	-75~+150
Nominal Output Voltage	Vh	V	$V_o \pm 2 \pm 0.050$ [at If(n)]
Load resistance	RL	Ω	10k
Offset Voltage	Vo	V	2.5 ± 0.050 [at 0A]
Supply Voltage	Vcc	V DC	+11.4~+12.6
Consumption Current	Icc	mA	15 Max.
Response Speed	Trr	μ sec	5 Max. [at di/dt=If(n)/μ sec]
Thermal Drift of Vh		%/°C	0.1 Max. [at If(n)]
Thermal Drift of Vo		mV/°C	±2 Max. [at 0A]
Dielectric Strength		kV	AC 2.5 [with 50 or 60 Hz 1min.]
Insulation Resistance		Ω	500M Min. [at 500V DC]
Operating Temperature	Ta	°C	-20 to +80
Storage Temperature	Ts	°C	-25 to +85
Hysteresis Error		mV	±20 Max. [at If --> 0]

Dimensions

Unit : mm

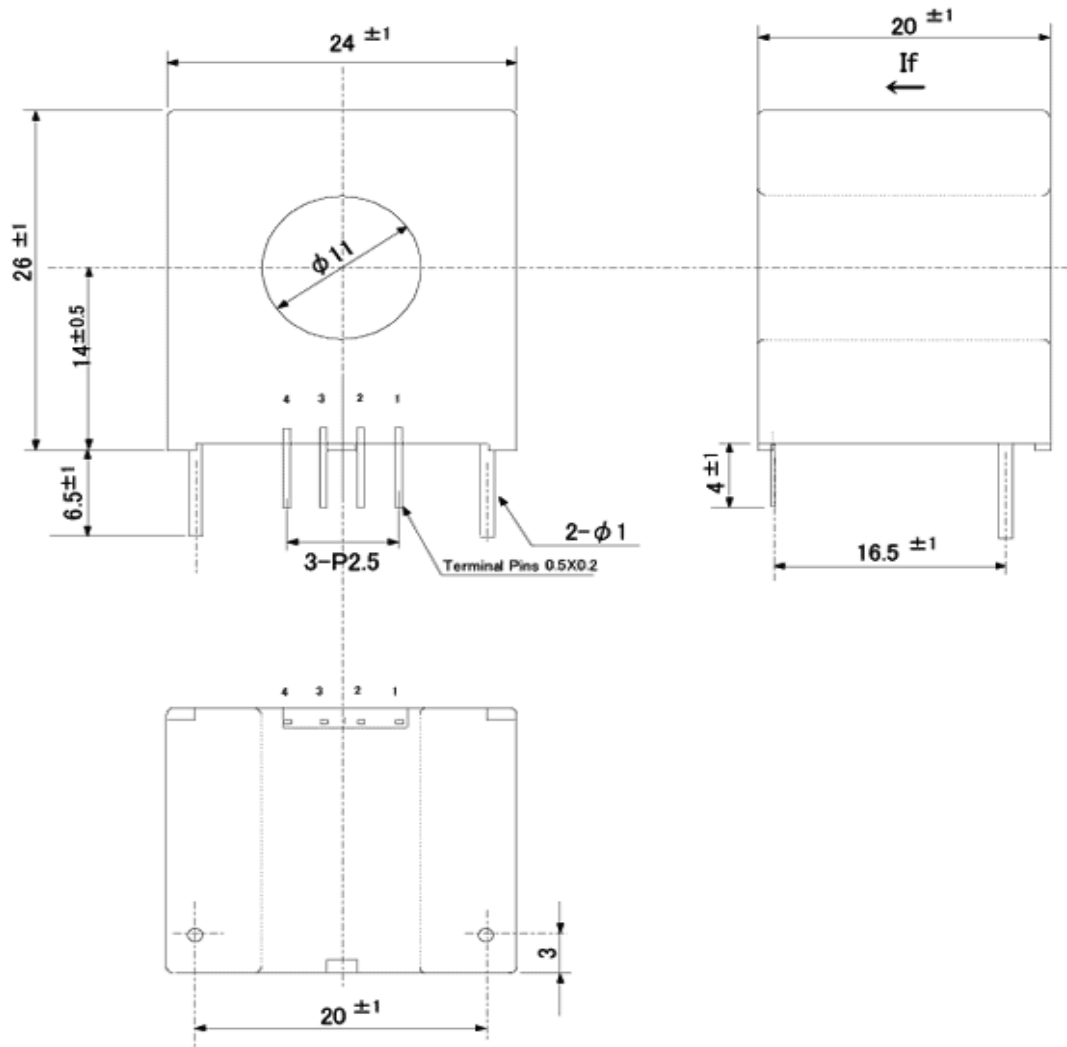

CK2-21020

Product Name	Mass
CK2-075S	19g

Connection

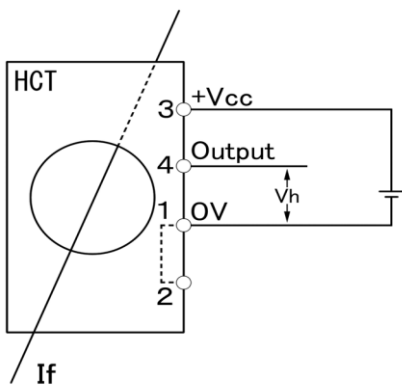

NANA ENGINEERING CO.,LTD.

1-22-5, Morino, Machida-shi, Tokyo 194-0022
 Machida 310 Irago building 4F
 E-Mail : nanaeng_sales@nana-e.com
 URL : <http://www.nana-e.com>